

QUANTUM EASY

Version

Worktop 84 cm - 600 m3/h

Collection

Cooking systems

EAN code

8034122900292



*The photograph is purely for information
It may not correspond to the selected version.*

FEATURES

Touch control
Residual heat indicators
Keep warm function: maximum temperature 70°
9 cooking levels + Double Booster
9 cooking levels + Power function (Over Boost)
Pot detector sensor
Timer / minute minder
Safety switch-off / safety lock function
Double Bridge Function
Automatic shut-off timer
Power management system on three levels: 2.8 kw, 3.5 kw, 7.4 kw
Brushless Motor
Touch control with LED display
Carbon.Zeo/Metallic filter maintenance warning
Auto mode (suction speed automatically adjusts to cooking power)
4 cooking areas with Flex Surface technology
Schott black ceramic glass
Motorized flap system
Black steel extraction area frame with surface scratchproof system

TECHNICAL FEATURES

Installation type
Worktop
Dimensions
84 cm
Finishing
Schott black ceramic glass
Motor
600 m³/h
Type of control
Touch control
Charcoal filter
KACL.963 Carbon and Zeolite anti-odor filter - Quantum Easy worktop (included)

PACKAGING:WEIGHTS AND VOLUMES

Gross weight
33 kg
Net weight
26.9 kg
Volumes
0.24 m³
Packaging size
Length
1055 mm
Height
375 mm
Depth
610 mm

CONSUMPTION AND CONNECTION FEATURES

Maximum consumption
7560 W
Voltage
220-240V
Frequency
50-60Hz
ENERGY CLASS
A+

OPTIONAL ACCESSORIES

KACL.963

KACL.963 Carbon and Zeolite anti-odor filter - Quantum Easy worktop

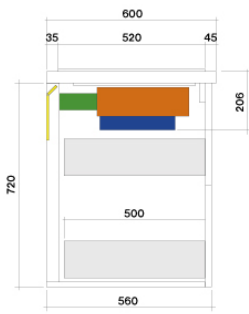

Side view

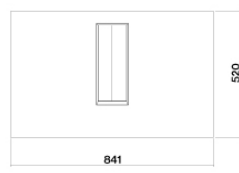

top view

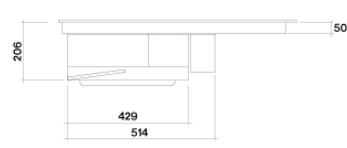

front view



Anti-noise conveyer

QUANTUM EASY

Version

Worktop 84 cm - 600 m3/h

Collection

Cooking systems

EAN code

8034122900292

ENERGY LABEL

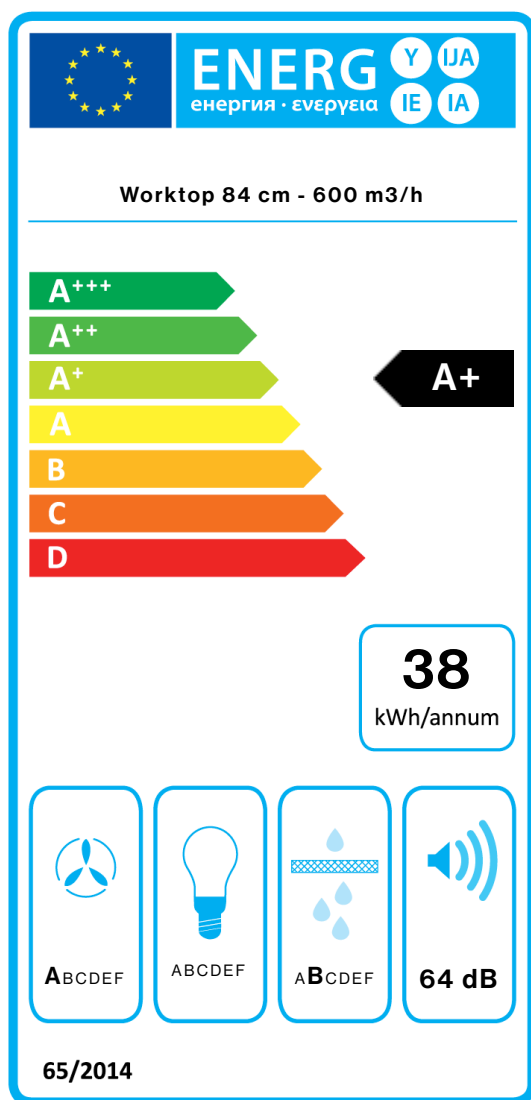

PF		
S	Falmec Spa	
M	Worktop 84 cm - 600 m3/h	
AEC	38,3	kWh/a
EEC	A+	
FDE	33,1	
FDEC	A	
LE	0,0	
LEC		
GFE	87,0	
GFEC	B	
Qmin	170,0	m³/h
Qmax	390,0	m³/h
Qboost	495,0	m³/h
SPEmin	46	dBa
SPEmax	64	dBa
SPEboost	69	dBa
PO	-	W
PS	0,48	W
PI		
F	0,8	
EEL	43,8	
Qbep	267,0	m³/h
Pbep	584	Pa
Qboost	495,0	m³/h
Wbep	131,0	W
WL	0,00	W
Emiddle	0	lux
Lwa-SPEmax	64	dBa

PF_Product fiche according to 65/2014 S_Supplier name / M_Model identification / AEC_Annual Energy Consumption (AEC hood) / EEC_Energy Efficiency class / FDE_Fluid Dynamic Efficiency (FDE hood) / FDEC_Fluid Dynamic Efficiency class / LE_Lighting Efficiency (LE hood) / LEC_Lighting Efficiency class / GFE_Grease Filtering Efficiency / GFEC_Grease Filtering Efficiency class / Qmin_Air flow (in m³/h) at min speed in normal use / Qmax_Air flow (in m³/h) at max speed in normal use / Qboost_Air flow (in m³/h) at intensive or boost setting (max air-flow) / SPEmin_Airborne acoustical A-weighted sound power emissions at min speed in normal use / SPEmax_Airborne acoustical A-weighted sound power emissions at max speed in normal use / SPEboost_Airborne acoustical A-weighted sound power emissions (in dB) at intensive or boost setting / PO_Power consumption in off mode (Po) / Ps_Power consumption in stand by mode (Ps). **PI_Additional information according to 66/2014** F_Time increase factor / EEL_Energy Efficiency Index / Qbep_Measured air flow rate at best efficiency point / Pbep_Measured air pressure at best efficiency point / Qboost_Maximum air flow / Wbep_Measured electric power input at best efficiency point / WL_Nominal power of the lighting system / Emiddle_Average illumination of the lighting system on the cooking surface / Lwa=SPEmax_Sound pressure level at the highest speed.