

SOPHIE

Version

Island - 54 cm - Worn copper -
600 m³/h

Designer

Collection

Circle.Tech

EAN code

8034122476872

FEATURES

Metallic grease filter, removable and washable

Combined Carbon.Zeo filter, regenerable

Remote control (optional)

Perimeter suction with tempered glass panel

Rotary Switch

Circle.Tech technology with

Carbon.Zeo Filters

Painted Steel with Worn Copper finish

Dynamic Light (2700K - 5600K)

Dialogue system

Strip LED 18w until 06.23.23

OPTIONAL ACCESSORIES

105080053

Remote control

KACL.143

Cables adjustable up to 340 cm

KACL.162#A4F

ø 22 cm lamp, Worn Copper

KACL.944

Carbon.Zeo spare filter kit for Circle.Tech hoods

TECHNICAL FEATURES

Installation type

Island

Dimensions

54 cm

Finishing

Painted steel worn copper

Motor

600 m³/h

Type of control

Rotary Switch

Speed

3 + boost

Lighting

Strip Led - 2700 K / 5600 K

Charcoal filter

Carbon.Zeo spare filter kit for Circle.Tech hoods (included)

Minimum distance

Gas hob: 53 cm

Electric hob: 52 cm

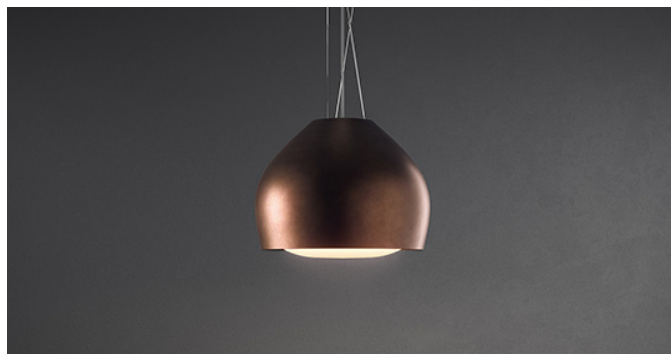

*The photograph is purely for information
It may not correspond to the selected version.*

PACKAGING:WEIGHTS AND VOLUMES

Gross weight

27 kg

Net weight

20.9 kg

Volumes

0.3 m³

Packaging size

Length

775 mm

Height

550 mm

Depth

705 mm

CONSUMPTION AND CONNECTION FEATURES

Maximum consumption

160 W

Voltage

220-240V

Frequency

50-60Hz

MOTOR TECHNICAL SHEET

Maximum noise level

66 dB(A)re1pW

I.E.C.60704-2-13

Max. motor power

130 W

ENERGY CLASS

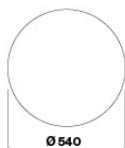
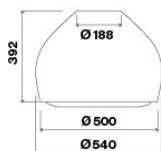

SOPHIE

Version

Island - 54 cm - Worn copper -
600 m³/h

Designer

Collection

Circle.Tech

EAN code

8034122476872

MOTOR TECHNICAL SHEET

Motor speed	1	2	3	4
Noise level dB(A)re1pW-I.E.C.60704-2-13	47	53	60	66
Capacity (m3/h) I.E.C.61591				
Maximum pressure (Pa)				
Power (W)	80	90	103	130
Air outlet				